



Universal Tower Bimini Tops Assembly and Installation Instructions

How to Prolong the Life of Your Bimini Top

- Avoid letting water or snow stand on the top.
- Always travel with top in the stored position inside the storage boot.
- When properly installed, you can safely deploy and use your bimini top with a maximum operating speed of 35 MPH.
- Allow bimini top to dry thoroughly before folding for storage.

Cleaning & Care Instructions

Scan QR Code or visit Page 4 to learn how to properly care for your bimini top canvas and frame.



Carver Limited Warranty

Scan QR Code or visit Page 4 to learn more about our limited product warranty.



Instruction/Informational Sheet	Page
Universal Tower Bimini Tops - Assembly	2
Universal Tower Bimini Tops - Installation	3
Bimini Top Cleaning & Care Instructions	4
Bimini Top Limited Warranty Information	4



Shown w/ the Double Brace Option

Carver Universal Tower Bimini Tops are a classy way to protect yourself and your boat from the elements. They also add style and color to your boat. These instructions make assembly and installation easy. **Please read them carefully before beginning.**



Please take extra care when unpacking and installing your bimini top. Should you need to return the bimini top, it **MUST** be in its original, new condition. The bimini top canvas must be clean and dry, and free of debris (including pet hair). Frame components must not be scratched.

Important: Make sure all parts are included in your bimini top package. The quantities listed below are the quantities of parts needed based on the size of the top that was ordered. You may receive additional parts that are not needed for your particular size of bimini top.

Note: Be sure bimini top dimensions match the mounting locations on your boat before assembling the bimini top and before drilling holes in your boat.

PARTS LIST:

QUANTITIES FOR:

Item	Top w/o Braces	Top w/ Single Brace Option (OPTD1)	Top w/ Double Brace Option (OPTD2)
No. 8 Screws - 1/2" Length	16	16	16
No. 10 Screws - 1" Length	8	4	0
Finish Washers	4	2	0
Long, Metal Side Bow Sections	2	2	2
Medium, Metal Side Bow Sections	2	2	2
Short, Metal Side Bow Sections	3	3	3
Center Metal Cross Bow Sections (equal length)	3	3	3
Black, 1" Polypropylene Hold-Down Straps	4	2	0
Bimini Top Canvas	1	1	1
Tower Clamps	2	4	6
Rubber Gaskets	2	4	6
Thumb Screws	2	4	6
1/4" Spacer (used w/ Thumb Screws)	2	4	6
Allen Wrench	1	1	1
Eye Straps	4	2	0
24" Aluminum Braces	0	2	4
Hinged Jaw Slides	0	2	4
Matching Storage Boot	1	1	1

Minimum Tools Needed: Drill with 9/64" bit, a Phillips head and a flat head screwdriver, pencil and 4mm or 1/8" Hex Bit Allen Wrench.

Also helpful: Tape measure or other measuring device.



Polypropylene Hold-Down Straps w/ Single Snap Hook



Tower Clamps



Eye Straps



Brackets w/ Spacers, Thumb Screws & Rubber Gaskets



No. 8, No. 10 Screws and Finish Washers



Short, Medium and Long Metal Side Bow Sections



Center Metal Cross Bow Section

For fully assembled bimini top installation instructions, please see Page 3.

These instructions show how to assemble the top, with its frame and straps, starting upside down and inverting to an upright position when attaching to your boat.

1. Identify the hook shaped, long, medium, and short metal side bow sections. All bows are color coordinated with stickers:
Long Bow = Red / Medium Bow = White / Short Bow = Blue

Using the long side bow sections, and the coordinated color coded center cross bow section, assemble the side bow and center bow parts as shown, aligning the pre-drilled holes. Use the 1/2", no. 8 screws to connect the bow parts securely (see figure 1).

Repeat this procedure for the medium and short bows, aligning the pre-drilled holes and securing them with 1/2", no. 8 screws.

Caution: If screw heads become burred, cover heads with duct tape to avoid damage to canvas.

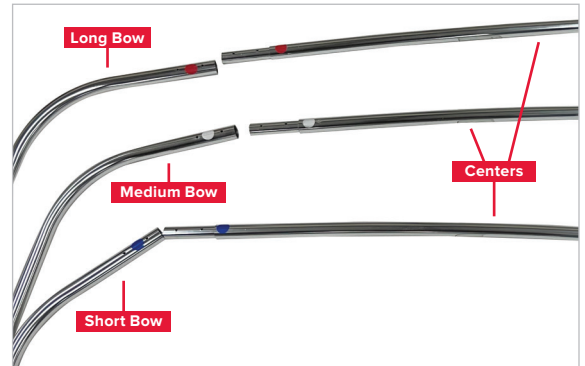
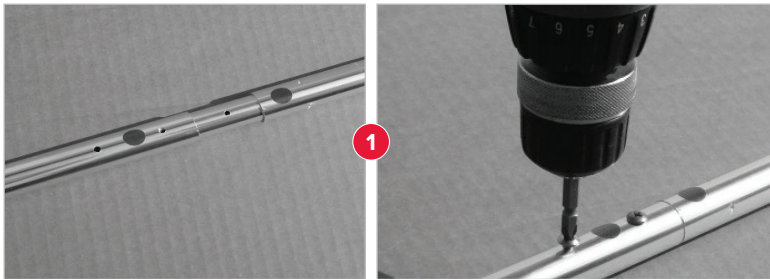

2. Spread the bimini top canvas out on a flat, clean area with the bottom side up. Sewn-in label indicates the bottom, or inside, and the back of the top.
3. With the bows assembled, insert the medium bow assembly through the sleeve at the front of top. (This is the sleeve opposite the end with the sewn-in tag.) *Note the position of the single pre-drilled holes on the bow frame. (Holes should be facing toward the middle of the canvas.)* Insert the short bow assembly through the small sleeve in the center of the top and the long bow assembly through the sleeve at the back of the top (nearest the sewn-in tag). The jaw slides should be facing down on the long bow. *Again, note the position of the single pre-drilled holes on the long bow frame. (Holes should be facing toward the middle of the canvas.)*
4. Pass looped end of each hold-down strap over each end of the long and medium bows. Be sure adjuster buckle is facing out. Use a No. 8, 1/2" screw and one finish washer to fasten the strap to the bow at the pre-drilled hole (as shown in figures 4A & 4B). Position strap over hole and insert screw, with finish washer, through center of strap and into pre-drilled hole. Be sure the screws for the hold-down straps are facing down. Important note: If you purchased the single brace kit, you will only install the hold-down straps on the medium bows. If you purchased the double brace kit – you will skip this step altogether.
5. Connect short frame ends to jaw slides on each side of long bow frame. Inside eye ends can be rotated to align with jaw slides. Repeat for medium bow as shown. Jaw slides should allow bows to pivot, but be tight enough to hold securely.

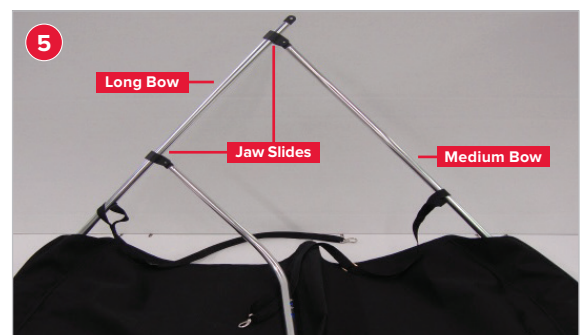

See Page 3 for installation instructions for mounting the bimini top onto your boat.

1. Place the folded bimini top in the storage boot
2. Using the straps on the boot, secure the bimini to the top of the tower adjusting the straps to the desired storage height (typically beneath the speakers, if applicable).
3. Prepare to install the tower clamps. Clamps are standard 2-3/8" inside diameter. A 3-foot length of black rubber gasket is provided for each clamp. If the diameter of your tower is smaller than 2-3/8", wrap a sufficient amount of rubber gasket around the tower so that the clamp will fasten tightly around the tower leg. For 1-7/8" diameter towers, the entire 3-foot length of gasket will be used. For 2-3/8" tower diameter, a single wrap of gasket will help prevent the clamp from scratching the tower.
4. Using the Allen wrench provided, install the tower clamps on the rear tower legs parallel to the bottom fittings on the bimini frame. The tower clamps should be positioned with the thumb screw facing the inside of the boat. Since no drilling is required, the tower clamps may easily be adjusted as needed.
5. Using the thumb screws and 1/4" spacers provided, attach the bimini to the tower clamps and disconnect the boot straps so that the bimini drops to the rear. **Note:** Each spacer should be positioned so that it rests against flat side of the tower clamp. This allows the eye end to rotate freely on the thumb screw.
6. Unzip the boot and deploy the bimini. Pivot the bimini upward to install the adjustable hold-down straps located at each corner of the bimini top (if applicable).
7. Mark the position of the eye straps* on the gunnel of the boat, measuring to make sure they are exactly opposite each other on each side of the boat. The position of the eye straps should be such that 45 to 90 degree angles are formed with the front and rear bow (a wide letter "M" as shown) when the hold-down straps are secured. Be sure to leave room for strap adjustment! ***If you ordered the double brace kit, skip this step and go to step 10. If you ordered the single brace kit, you'll install only the front eye straps.**
8. Use a drill with a 9/64" bit to drill the pilot holes for the eye straps (if applicable). When drilling into fiberglass, be sure to hollow out the pilot holes slightly with the drill bit. Secure the eye straps with the No. 10 x 1" sheet metal screws provided. Attach the hold-down straps to the eye straps.
9. Adjust the bimini to the desired position by adjusting the front and rear hold-down straps. Make sure the canvas is as taut as possible to prevent loose fabric from whipping in the wind.
10. If you ordered brace options (either single or double) with your tower bimini, the braces are easy to adjust and install. All braces are 24" long, standard. To reduce the length of a brace, simply remove the eye end by loosening the set screw. Cut the brace to the desired length using a hacksaw and replace the eye end. Fasten the hinged jaw slide to the frame by tightening the set screw and securing the eye end to the bolt on the jaw slide. Attach the opposite end of the brace to the tower with the tower clamp, spacer and thumb screw (refer to step 5), thumb screws toward the inside of the boat.



Tower Bimini, Stored Position



Placement of the hold-down straps should form the letter "M". Straps should form a 45 to 90 degree angle with each bow.



Optional braces are easy to adjust and install.



Bimini Top Care Instructions & Limited Warranty Information

CARING FOR YOUR BIMINI TOP CANVAS:

Clean bimini top canvas regularly to remove salt, pollen and environmental pollutants that could support the growth of mildew. To keep your canvas looking its best, regularly brush off any loose dirt or soil with a soft brush and rinse with lukewarm water (100° F maximum). To clean, a solution of lukewarm water and mild, **non-detergent** soap (such as Dreft, Ivory, Lux or Woolite) may be used. Rinse thoroughly and allow to air dry. The use of detergents is not recommended as it may diminish the water repellent finish on certain fabrics. Never machine wash, dry clean or iron the canvas. To spot clean stubborn soil or stains, a solution of 1/4 cup mild natural soap and 1 cup of bleach per gallon of lukewarm water may be used. Mist the soiled area and clean vigorously with a sponge, soft brush or clean towel. Rinse thoroughly and allow to air dry.

If water repellency is diminished, we recommend re-treating the canvas with 303® Fabric Guard. Allow canvas to dry thoroughly before folding for storage. Always fold down and secure bimini top in the stored position inside the storage boot when trailering your boat and/or when the top is not in use. Never allow water or snow to “pool” on the bimini top.

CARING FOR YOUR BIMINI TOP FRAME:

To maintain the appearance of your bimini top frame, simply wipe regularly with a soft, non-abrasive cloth and warm water to remove environmental pollutants, finger prints and other outdoor soils. If desired, mild, non-detergent soap may be used. Rinse thoroughly and wipe dry.



Scan QR Code for more information on bimini top care and maintenance.

Carver Bimini Top Limited Warranty

Carver guarantees that the materials and craftsmanship of their products are free from defects upon manufacturing.

The length of the warranty depends on the specific product line and material type and starts from the original date of purchase for the original owner (replacements or pro-rated replacements do not extend the warranty). The length of the warranty is determined by the type of material ordered.

The warranty does not cover natural events, normal wear and tear, weather damage, stains from pollution or water, cuts from sharp objects, neglect, accidents, or misuse. Tree sap, improper chemicals, cleaning agents, gasoline, oils, and other liquids not recommended for cleaning are also not covered. Any damage caused by animals such as rodents, birds, pets or insects is not covered in the warranty.

Proper installation, usage, and maintenance of the boat cover, PWC cover, or Bimini Top are necessary for warranty coverage.

Carver fabrics are water resistant, not waterproof; they must be breathable to allow condensation, heat, and moisture to evaporate from under the cover. Damage from pooled water will not be included in these warranties.

Please visit www.CarverCovers.com/About-Carver/Product-Warranty-Information/ for detailed limited warranty information or scan QR code below.



Call before returning product under warranty to receive a Return Merchandise Authorization Number (RMA#) at 864-457-5820, then send warranty claims to:

Mailing/Shipping Address

Carver by Covercraft Industries, LLC
212 N. Lyles Ave., Landrum, SC 29356

Please enclose a note describing the defect and be sure to include your full name, address and phone number inside the package.

***If you need return assistance with your order that is less than 30 days old - please contact the original place of purchase for return authorization.**